

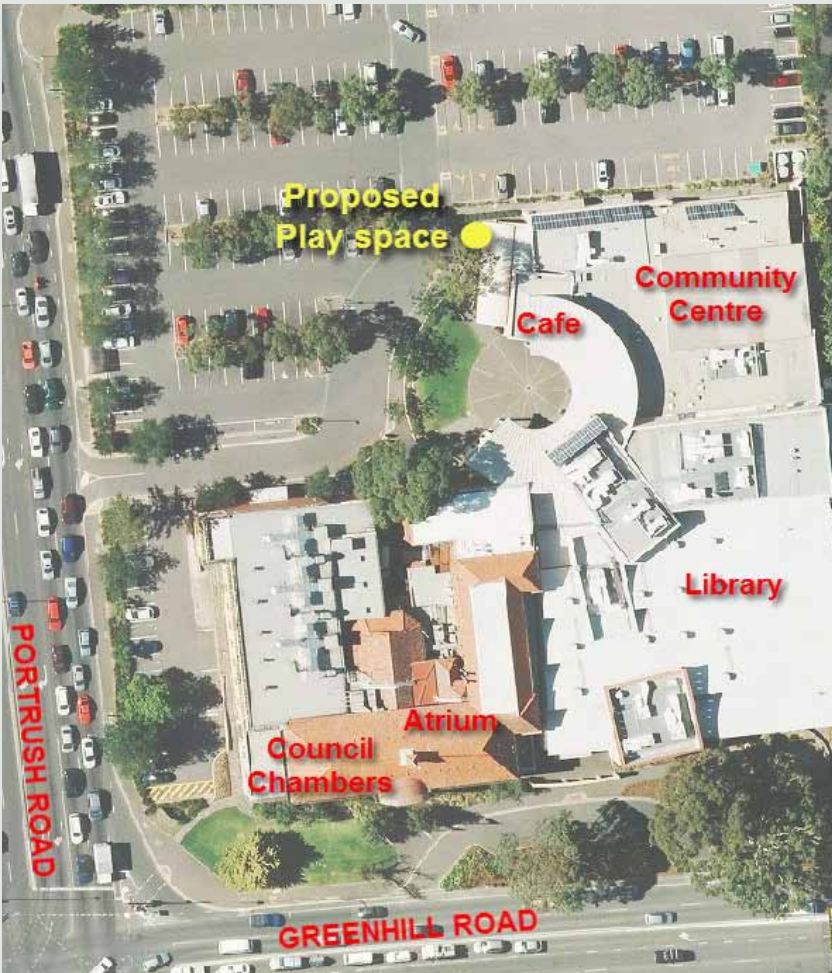

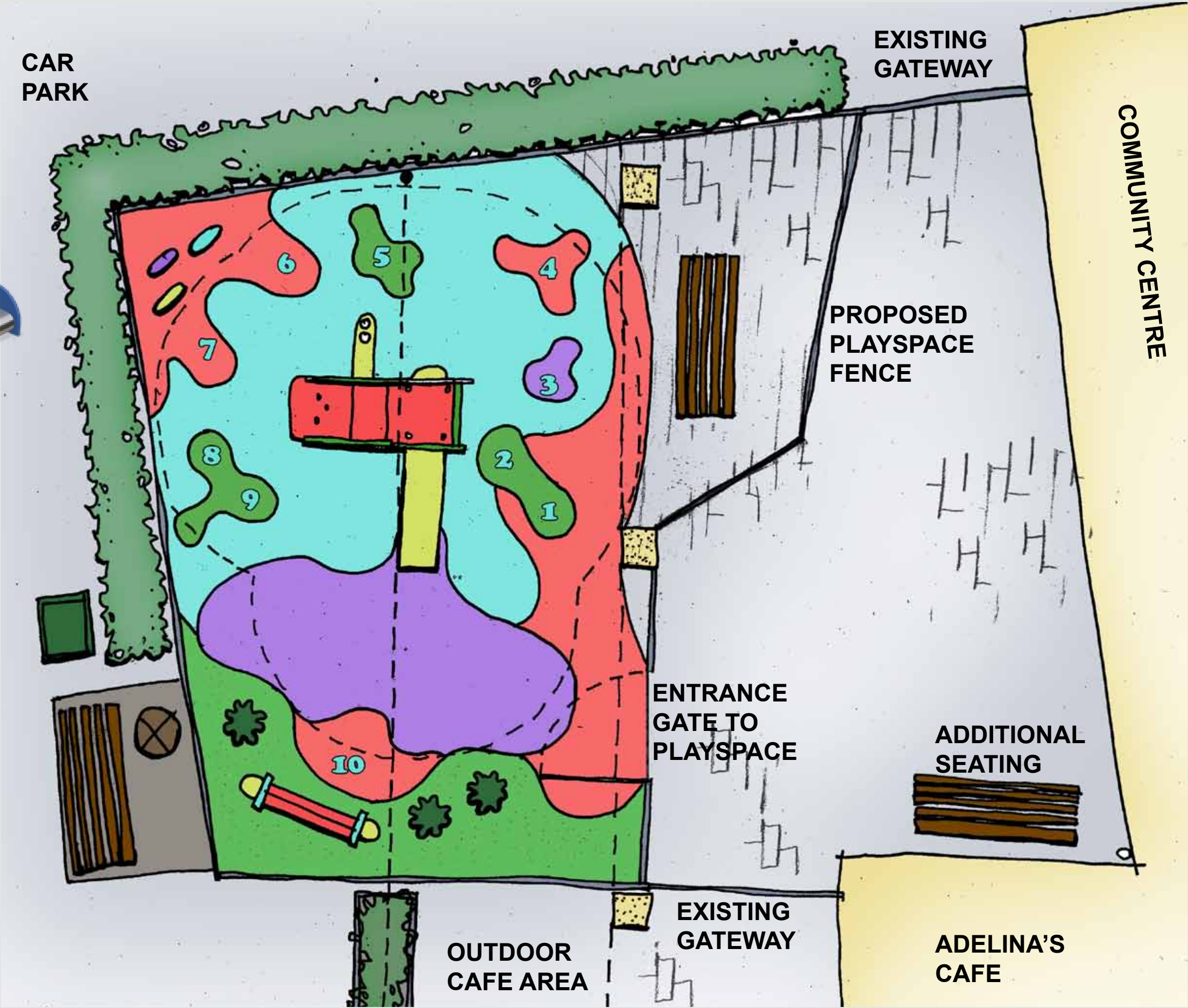

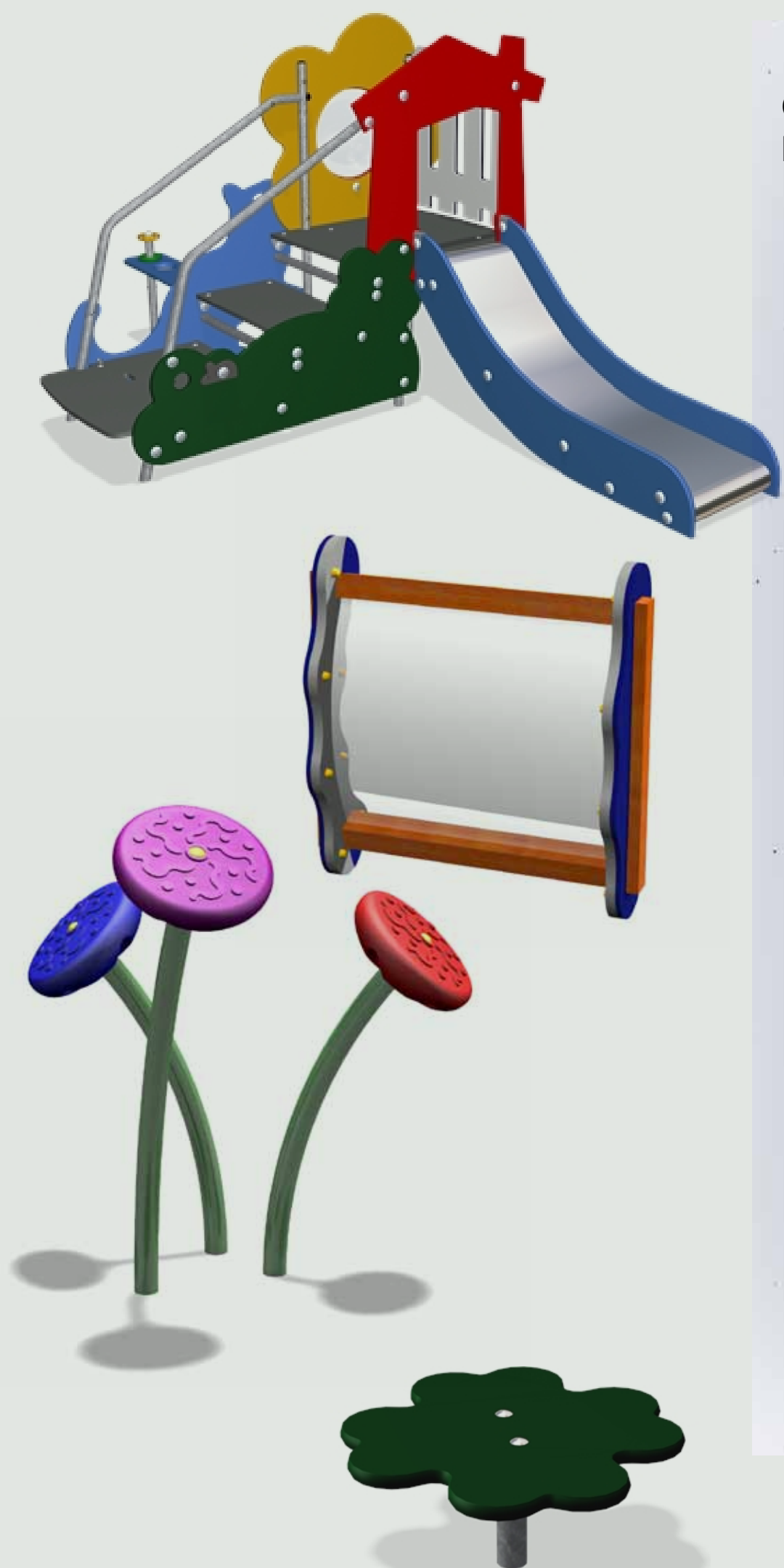





# Civic Centre Play Space 2014

## Fenced toddler play space

The concept design proposes installing fencing to separate the playspace to the walkway. Rubber surfacing with a variety of colours and patterns will define the playspace, creating pathways, stepping stones and games. A small slide and play structure, distortion mirror, toddler seats/steps and interactive 'flowers' aim to offer a variety of activities within the allowable space. The current seat will become part of the playspace and a new seat will be installed against the wall of the community centre to ensure seating is available for different users of the space.

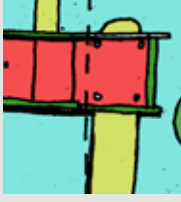

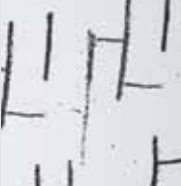
### LEGEND

	INTERACTIVE 'FLOWERS'		ARTIFICIAL TURF
	NUMBERED RUBBER STEPPING STONES		COLOURED RUBBER SOFT FALL
	"CLOVER" STEPS/ SEATS		TODDLER SLIDE AND PLAY STATION
	DISTORION MIRROR		SEATING
	EXISTING PAVED AREA		BUILDING COLUMN